

Tryckmätare

syrafast serie 131.11

husdim 40, 50 och 63 mm

Datablad **02.08.06**

utg.23.01

Utförande	Tryckmätare i syrafast utförande för mätning av flytande eller gasformiga, aggressiva mätmedier.
Design	EN 837-1
Serie	131.11
WIKA typnr	131.11
Husdiameter	Dim 40, 50 eller 63 mm
Mätnoggrannhet	kl. 2,5%. Option med mätnoggrannhet kl. 1,6%
Hus	Syrafast stål 1.4301 Option med blow-out disc och/eller polerat hus Option med pressad kapsel
Glas	Akrylglas. Option med instrumentglas eller säkerhetsglas
Mätsystem	Medieberörda delar av syrafast stål 316 L
Verk	Syrafast stål
Tryckenhet	Bar. Option med enhet bar/Pa, bar/psi, kPa, MPa, psi
Skala	Vit skala av aluminium
Tryckanslutning	G1/8", G1/4", 1/8"NPT eller 1/4"NPT Option med monterad strypskruv i tryckkanalen
Montering	Fristående montering nedåt eller bakåt, frontfläns eller bygelmontage för panelmontage
Skyddsklass	IP 54 enligt EN 60529/IEC 529. Option med IP 65
Tillåtet arbetstryck	75% av skalvärdet vid vilande belastning. 66% av skalvärdet vid växlande belastning Hela skalvärdet vid tillfällig belastning
Tillåten temperatur	Medietemperatur max -40 till +100°C Omgivningstemperatur -40 till +60°C Option med omgivningstemperatur till max +130°C
Certifikat	Certifikat EN 10204 kan levereras mot tillägg Materialintyg EN 10204-2.2 Materialcertifikat EN 10204-3.1
Kalibrering	Option med ackrediterad kalibrering med kalibreringsbevis enligt ISO/IEC 17025:2018 (SWEDAC)
Specialutförande	ATEX protection c with device cat 2G/2D Utförande fettfri för syrgas Silikonfritt utförande Skala med färgade fält eller kundlogo



Tryckmätare

syrafast serie 131.11

husdim 40, 50 och 63 mm

Datablad **02.08.06**



Tryckområde	Skalvärde	Delstreck
0-0,6 bar	0,02	30
0-1 bar	0,05	20
0-1,6 bar	0,05	32
0-2,5 bar	0,1	25
0-4 bar	0,2	20
0-6 bar	0,2	30
0-10 bar	0,5	20
0-16 bar	0,5	32
0-25 bar	1,0	25
0-40 bar	2,0	20
0-60 bar	2,0	30
0-100 bar	5,0	20
0-160 bar	5,0	32
0-250 bar	10,0	25
0-400 bar	20,0	20
0-600 bar	20,0	30
0-1000 bar *	50,0	20
-1/0 bar	0,05	20
-1/+1,5 bar	0,1	25
-1/+3 bar	0,2	20
-1/+5 bar	0,2	30
-1/+9 bar	0,5	20
-1/+15 bar	0,5	32

* 1000 bar endast med husdimension 63 mm

Mätnoggrannhet

Max tillåten onoggrannhet 2,5%

Mätnoggrannheten räknas i procent av tryckmätarens slutgradering. Avvikelsen 2,5% kan förekomma \pm över hela skalområdet vid normaltemperatur +20°C.
Ex. tryckområde 0-10 bar har avvikelse \pm 0,25 bar

Temperaturpåverkan









Temperatur över eller under +20°C påverkar noggrannheten. Driftstemperatur över eller under +20°C försämrar noggrannheten med 0,4 procentenheter per +10°C.
Ex vid driftstemperatur +40°C är onoggrannheten \pm 3,3%.

Tryckmätare

syrafast serie 131.11

husdim 40, 50 och 63 mm

Datablad **02.08.06**









Best.nr husdim 40 skala Bar								
	131.11.040	131.11.040	131.11.040	131.11.040	131.11.040	131.11.040	131.11.040	131.11.040
Montering	Nedåt	Nedåt	Nedåt	Nedåt	Bakåt	Bakåt	Bakåt	Bakåt
Anslutning	G1/8"	G1/4"	1/8" NPT	1/4" NPT	G1/8"	G1/4"	1/8" NPT	1/4" NPT
0-1 bar	13100202	13100302	13100702	13100802	13110202	13110302	13110702	13110802
0-1,6 bar	13100203	13100303	13100703	13100803	13110203	13110303	13110703	13110803
0-2,5 bar	13100204	13100304	13100704	13100804	13110204	13110304	13110704	13110804
0-4 bar	13100206	13100306	13100706	13100806	13110206	13110306	13110706	13110806
0-6 bar	13100207	13100307	13100707	13100807	13110207	13110307	13110707	13110807
0-10 bar	13100208	13100308	13100708	13100808	13110208	13110308	13110708	13110808
0-16 bar	13100211	13100311	13100711	13100811	13110211	13110311	13110711	13110811
0-25 bar	13100213	13100313	13100713	13100813	13110213	13110313	13110713	13110813
0-40 bar	13100215	13100315	13100713	13100813	13110215	13110315	13110713	13110813
0-60 bar	13100217	13100317	13100717	13100817	13110217	13110317	13110717	13110817
0-100 bar	13100219	13100319	13100719	13100819	13110219	13110319	13110719	13110819
0-160 bar	13100220	13100320	13100720	13100820	13110220	13110320	13110720	13110820
0-250 bar	13100222	13100322	13100722	13100822	13110222	13110322	13110722	13110822
0-315 bar	13100223	13100323	13100723	13100823	13110223	13110323	13110723	13110823
0-400 bar	13100224	13100324	13100724	13100824	13110224	13110324	13110724	13110824
0-600 bar	13100225	13100325	13100725	13100825	13110225	13110325	13110725	13110825
0-1000 bar	x	x	x	x	x	x	x	x
-1/0 bar	13100240	13100340	13100740	13100840	13110240	13110340	13110740	13110840
-1/+1,5 bar	13100266	13100366	13100766	13100866	13110266	13110366	13110766	13110866
-1/+3 bar	13100267	13100367	13100767	13100867	13110267	13110367	13110767	13110867
-1/+5 bar	13100268	13100368	13100768	13100868	13110268	13110368	13110768	13110868
-1/+9 bar	13100269	13100369	13100769	13100869	13110269	13110369	13110769	13110869
-1/+15 bar	13100271	13100371	13100771	13100871	13110271	13110371	13110771	13110871

Tryckmätare

syrafast serie 131.11

husdim 40, 50 och 63 mm

Datablad **02.08.06**









Best.nr husdim 50 skala Bar								
	131.11.050	131.11.050	131.11.050	131.11.050	131.11.050	131.11.050	131.11.050	131.11.050
Montering	Nedåt	Nedåt	Nedåt	Nedåt	Bakåt	Bakåt	Bakåt	Bakåt
Anslutning	G1/8"	G1/4"	1/8" NPT	1/4" NPT	G1/8"	G1/4"	1/8" NPT	1/4" NPT
0-1 bar	13200202	13200302	13200702	13200802	13210202	13210302	13210702	13210802
0-1,6 bar	13200203	13200303	13200703	13200803	13210203	13210303	13210703	13210803
0-2,5 bar	13200204	13200304	13200704	13200804	13210204	13210304	13210704	13210804
0-4 bar	13200206	13200306	13200706	13200806	13210206	13210306	13210706	13210806
0-6 bar	13100207	13200307	13200707	13200807	13210207	13210307	13210707	13210807
0-10 bar	13200208	13200308	13200708	13200808	13210208	13210308	13210708	13210808
0-16 bar	13200211	13200311	13200711	13200811	13210211	13210311	13210711	13210811
0-25 bar	13200213	13200313	13200713	13200813	13210213	13210313	13210713	13210813
0-40 bar	13200215	13200315	13200713	13200813	13210215	13210315	13210713	13210813
0-60 bar	13100217	13200317	13200717	13200817	13210217	13210317	13210717	13210817
0-100 bar	13200219	13200319	13200719	13200819	13210219	13210319	13210719	13210819
0-160 bar	13200220	13200320	13200720	13200820	13210220	13210320	13210720	13210820
0-250 bar	13200222	13200322	13200722	13200822	13210222	13210322	13210722	13210822
0-315 bar	13200223	13200323	13200723	13200823	13210223	13210323	13210723	13210823
0-400 bar	13200224	13200324	13200724	13200824	13210224	13210324	13210724	13210824
0-600 bar	13200225	13200325	13200725	13200825	13210225	13210325	13210725	13210825
0-1000 bar	x	x	x	x	x	x	x	x
-1/0 bar	13200240	13200340	13200740	13200840	13210240	13210340	13210740	13210840
-1/+1,5 bar	13200266	13200366	13200766	13200866	13210266	13210366	13210766	13210866
-1/+3 bar	13200267	13200367	13200767	13200867	13210267	13210367	13210767	13210867
-1/+5 bar	13200268	13200368	13200768	13200868	13210268	13210368	13210768	13210868
-1/+9 bar	13200269	13200369	13200769	13200869	13210269	13210369	13210769	13210869
-1/+15 bar	13200271	13200371	13200771	13200871	13210271	13210371	13210771	13210871

Tryckmätare

syrafast serie 131.11

husdim 40, 50 och 63 mm

Datablad **02.08.06**

Best.nr husdim 63 skala Bar								
	131.11.063	131.11.063	131.11.063	131.11.063	131.11.063	131.11.063	131.11.063	131.11.063
Montering	Nedåt	Nedåt	Nedåt	Nedåt	Bakåt	Bakåt	Bakåt	Bakåt
Anslutning	G1/8"	G1/4"	1/8" NPT	1/4" NPT	G1/8"	G1/4"	1/8" NPT	1/4" NPT
0-1 bar	13300102	13300202	13300402	13300302	13310102	13310202	13310402	13310302
0-1,6 bar	13300103	13300203	13300403	13300303	13310103	13310203	13310403	13310303
0-2,5 bar	13300104	13300204	13300404	13300304	13310104	13310204	13310404	13310304
0-4 bar	13300106	13300206	13300406	13300306	13310106	13310206	13310406	13310306
0-6 bar	13300107	13300207	13300407	13300307	13310107	13310207	13310407	13310307
0-10 bar	13300108	13300208	13300408	13300308	13310108	13310208	13310408	13310308
0-16 bar	13300111	13300211	13300411	13300311	13310111	13310211	13310411	13310311
0-25 bar	13300113	13300213	13300413	13300313	13310113	13310213	13310413	13310313
0-40 bar	13300115	13300215	13300413	13300315	13310115	13310215	13310413	13310315
0-60 bar	13300117	13300217	13300417	13300317	13310117	13310217	13310417	13310317
0-100 bar	13300119	13300219	13300419	13300319	13310119	13310219	13310419	13310319
0-160 bar	13300120	13300220	13300420	13300320	13310120	13310220	13310420	13310320
0-250 bar	13300122	13300222	13300422	13300322	13310122	13310222	13310422	13310322
0-315 bar	13300123	13300223	13300423	13300323	13310123	13310223	13310423	13310323
0-400 bar	13300124	13300224	13300424	13300324	13310124	13310224	13310424	13310324
0-600 bar	13300125	13300225	13300425	13300325	13310125	13310225	13310425	13310325
0-1000 bar	13300126	13300226	13300426	13300326	13310126	13310226	13310426	13310326
-1/0 bar	13300140	13300240	13300440	13300340	13310140	13310240	13310440	13310340
-1/+1,5 bar	13300166	13300266	13300466	13300366	13310166	13310266	13310466	13310366
-1/+3 bar	13300167	13300267	13300467	13300367	13310167	13310267	13310467	13310367
-1/+5 bar	13300168	13300268	13300468	13300368	13310168	13310268	13310468	13310368
-1/+9 bar	13300169	13300269	13300469	13300369	13310169	13310269	13310469	13310369
-1/+15 bar	13300171	13300271	13300471	13300371	13310171	13310271	13310471	13310371

Tryckmätare

syrafast serie 131.11

husdim 40, 50 och 63 mm

Datablad **02.08.06**

Typ 131.11
nedåtriktad

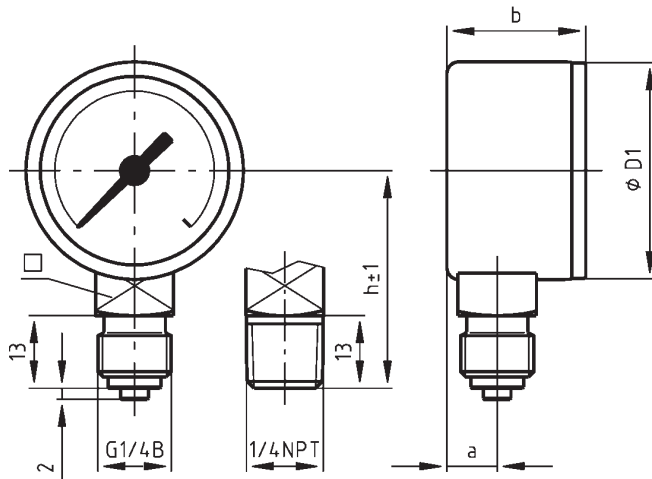

Typ 131.11
bakåtriktad

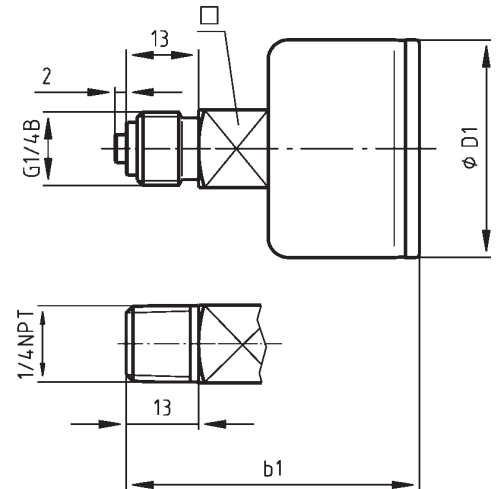

Typ 131.11
bakåtriktad
utförande med kapsel

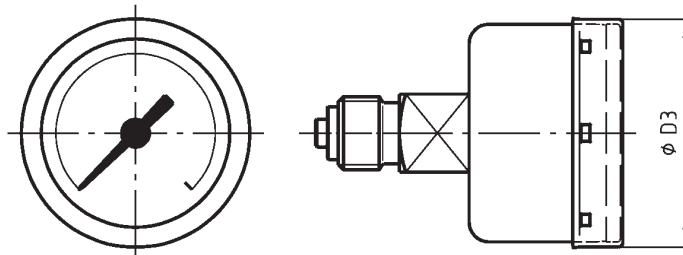

Dim Ø	a	b	b ₁	b ₂	D ₁	D ₃	x1	x2	g	h±1	f	c	kg	G
40	9	28	52,5	-	39	41	-	-	-	39	-	-	0,05	G1/4-1/4NPT
50	9,6	28	53,5	-	49	50	-	-	-	47	-	-	0,09	G1/4-1/4NPT
63	10	28	53,5	-	62	64	-	-	-	54	-	-	0,12	G1/4-1/4NPT